



EC DRIVES IN VTS DEVICES

SPECIFICATION, PROGRAMMING, OPERATION

TABLE OF CONTENT

1. SAFETY ISSUES.....	3
2. PRODUCT DESCRIPTION AND TECHNICAL SPECIFICATION	3
3. INSTALLATION	5
3.1 Cable requirements.....	5
3.2 Pinout	5
3.2.1 SR EC drives	5
3.2.2 SNMU EC drives.....	6
3.2.3 YLDA EC drives.....	7
3.2.4 WG EC drives.....	8
4. COMMUNICATION OPTIONS.....	9
4.1 Factory addressing and communication type.....	9
4.2 Modbus RTU.....	9
4.2.1 SR and WG EC drives	10
4.2.2 SNMU EC drives.....	12
4.2.3 YLDA EC drives.....	13
4.3 0-10V	15
5. Adaptation of new EC drives to work with VTS automation.....	15

Please read the following documentation carefully before installing, maintaining and operating EC drives. In case of doubt, contact the official VTS support. This manual may only be used by a qualified service representative.

1. SAFETY ISSUES

All drives described in this manual may only be operated, connected, installed, repaired and modified by qualified personnel. Failure to perform any of these operations correctly may result in death, electric shock, improper installation, or product damage. The installation should be carried out with undamaged cables and with proper grounding. Follow the pinout diagrams dedicated to your drives.

Do not open or disassemble the drive while power is connected to the device. This can cause fatal injury due to electric shock. If disassembly is necessary, wait at least 5 minutes after disconnecting from the power supply.

It is the responsibility of the user and installer to ensure that the system is properly grounded and protected in accordance with national and local standards. VTS is not responsible for any damages or injuries caused by incorrect installation, faulty electrical circuits or other failures.

2. PRODUCT DESCRIPTION AND TECHNICAL SPECIFICATION

Air handling units and other selected VTS devices can be equipped with various configurations of EC drives, tailored to the needs and requirements of customers.

Type	Subtype	Rated speed [RPM]	Rated current [A]	Regulator type - power [kW]	Supply voltage [V]
WG	Axial 350mm	1200	0.60	0.37	1x230
WG	Axial 420mm	1430	1.30	0.37	1x230
WG	Axial 450mm	1400	1.60	0.37	1x230
WG	EC092/25E3G01-02	1340	1.50	0.37	1x230
WG	EC092/35E3G01-02	1340	2.20	0.37	1x230
WG	EC102/50E3G04-02	1400	3.30	0.37	1x230
SR	Plug 190	4500	1.20	0.17	1x230
SR	Plug 225	3600	3.00	0.37	1x230
SR	Plug 225	4500	5.70	0.75	1x230
SR	Plug 250	3000	3.50	0.37	1x230
SR	Plug 250	3800	4.40	0.75	1x230
SNMU	Plug 310	3160	2.80	1.65	3x400
SNMU	Plug 355	3200	5.10	3.25	3x400
YLDA	Plug 250	3500	3.50	0.75	1x230
YLDA	Plug 250	4000	2.00	1.10	3x400
WG	EC102/50E3G01	3700	3.20	0.75	1x230
WG	EC137/40D3G01	3000	1.90	1.20	3x400
WG	EC137/80D3G81	2430	4.20	2.70	3x400
WG	EC180/55D3G01 (315)	4000	5.10	3.30	3x400
WG	EC180/85D3G01	2600	8.10	5.25	3x400
WG	EC180/55D3G01 (450)	2200	5.10	3.30	3x400

Table 1 – types of EC drives

VTS reserves the right to change the given configurations without prior notice. Any modifications or configuration changes other than those proposed must first be reported and consulted with the VTS technical department.

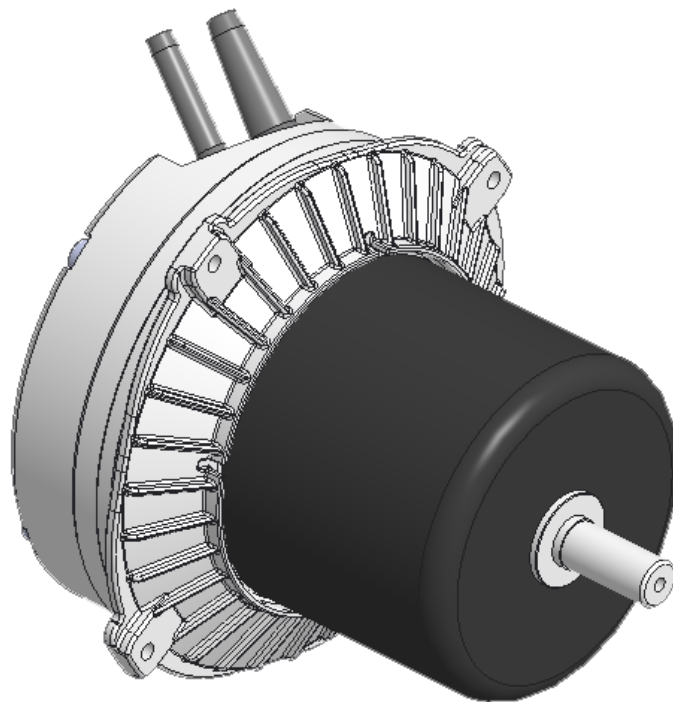

Picture 1 – 1-phase 0.75kW SR EC drive



Picture 2 – 3-phase 1.65kW SNMU EC drive

3. INSTALLATION

3.1 Cable requirements

In the case of modular AHUs (without factory wiring between the drives and the electrical box), only hard wire or copper wires with ferrules should be used for wiring.

The length of control cables should not exceed 20m for 0-10V control and 40m for Modbus control.

To reduce operational problems, control cables must be shielded.

Use cables that meet the voltage, current, load, and insulation requirements for the type of drive you are using.

Use appropriate protection in the electrical installation. If the fuses are damaged, replace them with the same value as those used at the factory.

Before connecting the power supply, make sure that the drive specifications on the nameplate match the supply voltage.

3.2 Pinout

3.2.1 SR EC drives

The SR EC drives are equipped with a common power supply and communication cable. It is terminated with a connector adapted for connection in AHU control boxes.

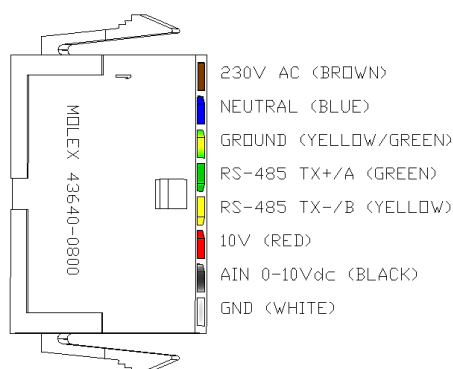

Picture 3 – 0.17 / 0.37 / 0.75kW SR EC drives power - control cable pinout

Color	Function	Remarks
green	RS485 A (+)	Modbus RTU
yellow	RS485 B (-)	Modbus RTU
red	10V output	-
black	0-10V input	-
white	0-10V GND	-
yellow - green	PE	-
brown	L	-
blue	N	-

Table 2 –SR EC drives pinout

3.2.2 SNMU EC drives

The SNMU EC drives are equipped with two separate cables: power supply and communication. They are terminated with cable sleeves and a connector. The cable with the connector (fault relay) is not used in VTS automation.

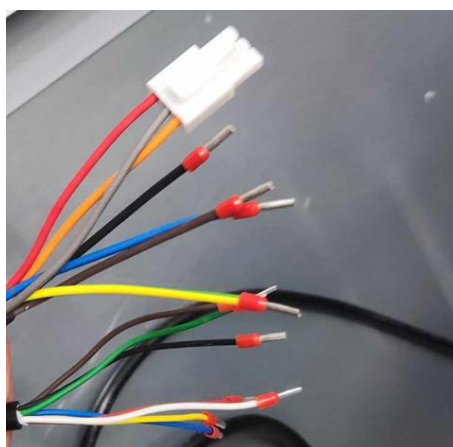

Picture 4 – 1.65 / 3.25kW SNMU EC drives power - control cable pinout

Color	Function	Remarks
brown	RS485 A (+)	Modbus RTU; there are two brown wires - the communication wire has a smaller cross-section than the power wire
black	RS485 B (-)	Modbus RTU; there are two black wires - the communication wire has a smaller cross-section than the power wire
green	RS485 GND	Modbus RTU
white	FG (pulse output)	2 pulses per rotation
red	10V output	-
yellow	0-10V input	-
blue	0-10V GND	there are two blue wires - the communication wire has a smaller cross-section than the power wire
brown	L1	there are two brown wires - the communication wire has a smaller cross-section than the power wire
blue	L2	there are two blue wires - the communication wire has a smaller cross-section than the power wire
black	L3	there are two black wires - the communication wire has a smaller cross-section than the power wire
yellow - green	PE	-
orange	NO contact of the fault relay	-
grey	COM contact of the fault relay	-
red	NC contact of the fault relay	-

Table 3 – SNMU EC drives pinout

3.2.3 YLDA EC drives

The YLDA EC drives are equipped with a connection terminal.

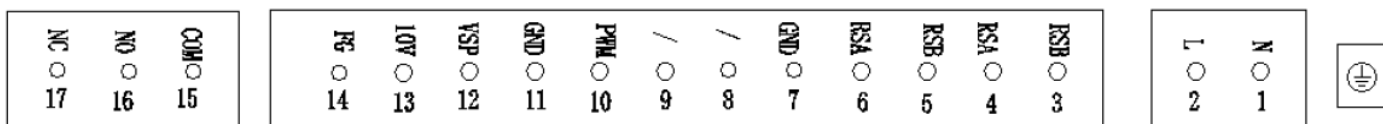

Picture 5 – 0.75kW YLDA EC drives connection terminal pinout

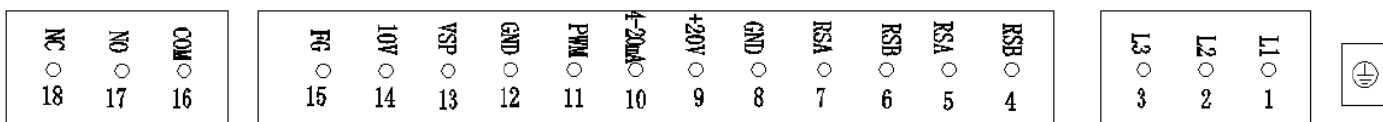

Picture 6 – 1.10kW YLDA EC drives connection terminal pinout

Description	Function	Remarks
PE	PE	-
N	N	only for single-phase drives
L	L	only for single-phase drives
L1	L1	only for three-phase drives
L2	L2	only for three-phase drives
L3	L3	only for three-phase drives
RSB	RS485 B (-)	Modbus RTU
RSA	RS485 A (+)	Modbus RTU
GND	input signals GND	-
+20V	20V output	only for three-phase drives
4-20mA	4-20mA input	only for three-phase drives
PWM	PWM input	5V 1k-10kHz
VSP	0-10V input	-
10V	10V output	-
FG	pulse output	1 pulse per rotation for single-phase drives; 12 pulses per rotation for three-phase drives
COM	COM contact of the fault relay	-
NO	NO contact of the fault relay	-
NC	NC contact of the fault relay	-

Table 4 – YLDA EC drives pinout

3.2.4 WG EC drives

The WG EC drives are equipped with a connection terminal.

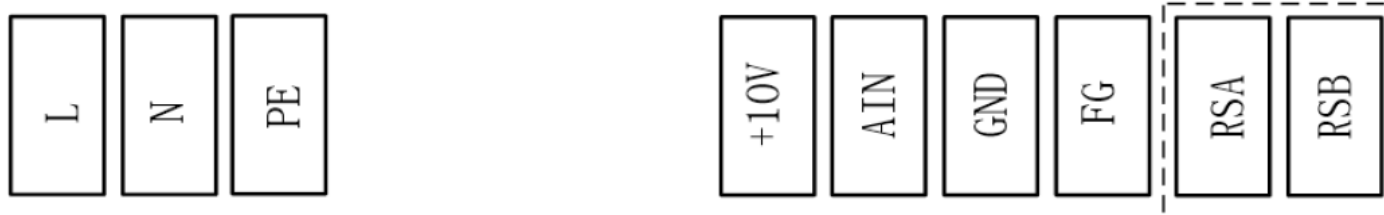

Picture 7 – 0.75kW WG EC drives connection terminal pinout

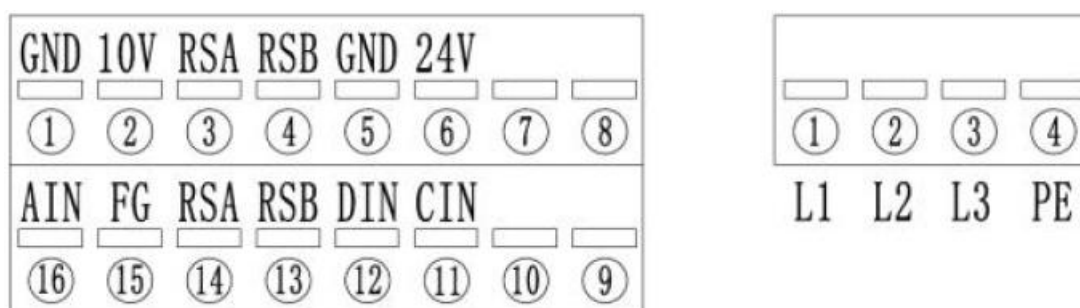

Picture 8 – 1.20kW WG EC drives connection terminal pinout

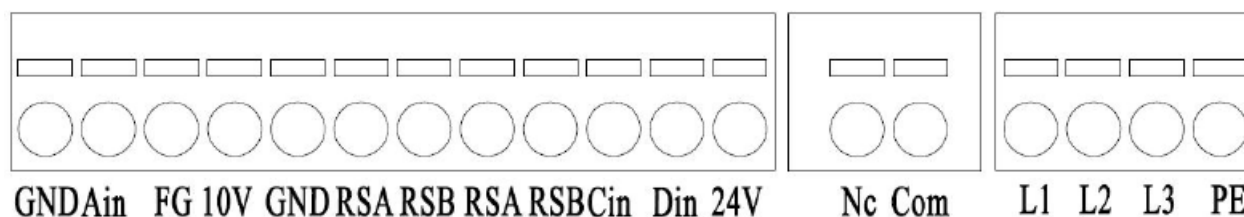

Picture 9 – 2.70 / 3.30 / 5.25kW WG EC drives connection terminal pinout

Description	Function	Remarks
L	L	only for single-phase drives
N	N	only for single-phase drives
PE	PE	-
L1	L1	only for three-phase drives
L2	L2	only for three-phase drives
L3	L3	only for three-phase drives
10V	10V output	-
AIN	0-10V / PWM input	-
GND	input signals GND	-
FG	pulse output	1 pulse per rotation
RSA	RS485 A (+)	Modbus RTU
RSB	RS485 B (-)	Modbus RTU
24V	24V output	only for three-phase drives
CIN	4-20mA input	only for three-phase drives
DIN	5-50V DC digital input	only for three-phase drives
NC	NC contact of the fault relay	only for 2.70 / 3.30 / 5.25kW three-phase drives
COM	COM contact of the fault relay	only for 2.70 / 3.30 / 5.25kW three-phase drives

Table 5 – WG EC drives pinout

4. COMMUNICATION OPTIONS

4.1 Factory addressing and communication type

EC drives are equipped with Modbus RTU and 0-10V control.

The table below shows the default settings of drives in factory-assembled VTS units depending on the type of the AHU:

X	Ventus		Compact			
			Standing		Suspended	
	Automation	No automation	Automation	No automation	Automation	No automation
Communication	Modbus	0-10V	Modbus	Modbus	Modbus	0-10V
Addresses	supply: 41,42,43,44,45,46,47,48,49,40 exhaust: 51,52,53,54,55,56,57,58,59,50					

Table 6 - factory settings of EC drives

Attention! The above settings apply only to factory-assembled VTS units. When ordering EC drives as spare parts (and for site-assembled units), please refer to the Table 14.

To enable correct communication between EC drives and the uPC3 controller, select the appropriate drive type in the first line of settings on the IO3 mask:

- **SR EC drives:** EC-G for motors with green impellers / EC-R for motors with red impellers
- **SNMU EC drives:** SNMU
- **YLDA EC drives:** YLDA
- **WG EC drives:** EC-G

4.2 Modbus RTU

The basic method of communication between EC drives and the AHU controller used in VTS automation is a serial transmission in the Modbus RTU (RS-485) protocol with the **parameters 9600/8/n/1**.

Drives control systems can be connected to the Modbus grid only by means of shielded cables (screens should be grounded on both sides).

Use parallel or daisy chain connection when connecting EC drives to the bus.

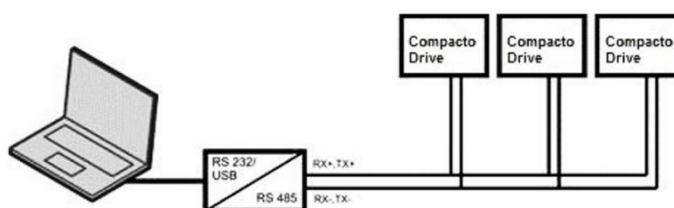

Picture 10 – parallel connection

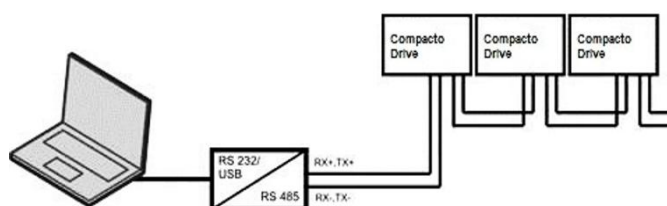

Picture 11 - "daisy chain" connection

4.2.1 SR and WG EC drives

Coils – read / write			
Address	Function	Range	Remarks
0	Motor on / off	0/1	1 = motor on (read only)
1	Controller reset	0/1	1 = controller reset

Table 7 – available Coils – SR and WG EC drives

Discrete Inputs – read / write			
Address	Function	Range	Remarks
0	Undervoltage	0/1	1 = voltage too low to operate
1	Overvoltage	0/1	1 = voltage too high to operate
2	IGBT overcurrent	0/1	1 = overcurrent protection active
3	Motor hot	0/1	1 = temperature protection active; power reduced
4	Phase loss	0/1	1 = phase or motor sync loss
6	Checksum error	0/1	1 = parameters checksum fail (TBD)
7	Circuit fault	0/1	1 = error was detected during internal check
8	Motor fault	0/1	1 = motor does not behave as expected
9	Controller hot	0/1	1 = controller too hot to operate
10	I2R IGBT fault	0/1	1 = software IGBT protection triggered
14	Restart fault	0/1	1 = fault condition repeated several times in a short time; controller should be power cycled
18	Waiting to stop	0/1	1 = motor should be stopped, but it is still spinning
24	RPM REG	0/1	1 = speed regulator active
25	POWER REG	0/1	1 = power limit regulator active
27	OVERMOD REG	0/1	1 = overmodulation; controller can no longer supply the voltage required by the motor
28	REGEN REG	0/1	1 = motor is in regeneration mode; RPM increased to avoid DC bus overvoltage
29	IPHASE REG	0/1	1 = RMS motor phase current limit reached
30	SYNC REG	0/1	1 = motor is in synchronous mode

Table 8 - available Discrete Inputs - SR and WG EC drives

Holding Registers – read / write				
Address	Function	Range	Resolution	Remarks
0	Setpoint	0 - 10000	0,01%	Speed setpoint 0 = stop 10000 = maximum speed
1	Direction	0/1	1	Rotation direction 0 = clockwise 1 = anti-clockwise
2	MAX RPM	MIN RPM - RATED RPM	1	Maximum allowed speed
4	MIN RPM	10% RATED RPM - MAX RPM	1	Minimum allowed speed
5	Password	0 - 32767	1	9788 = password for changing parameters 10000 = password for saving changes

6	Control mode	0/2	1	0 = 0-10V control 2 = Modbus control
7	Modbus address	1 - 247	1	Address in Modbus grid
8	Communication loss reaction	0/1	1	0 = motor stop when Modbus communication lost 1 = ignore
11	AN1 MAX	0 – 1000	0,01V	Control input voltage for maximum setpoint; operation reverse if AN1 MAX < AN1 MIN
12	AN1 MIN	0 – 1000	0,01V	Control input voltage for minimum setpoint
13	AN1 STOP	0 – 1000	0,01V	Control input voltage for stop
18	Baudrate	0/1/2/3	1	1 = 9600 2 = 19200 3 = 38400

Table 9 - available Holding Registers - SR and WG EC drives

Input registers - read				
Address	Function	Range	Resolution	Remarks
0	HW version	0 - 32767	1	Hardware version
1	FW version	0 - 32767	1	Firmware version
4	Speed	0 - 32767	1RPM	Actual motor speed
5	Temperature	-50 - 150	0,01°C	Controller temperature
6	DC voltage	0 - 32767	0,1V	DC bus voltage
7	Current	0 - 32767	0,001A	Motor current
8	Power	0 - 32767	0,1W	Electrical power
9	AN	-300 - 2000	0,01V	Analog input voltage
19	Fault code	0/1/2/3/4/ 5/6/7	1	Fault code (ordered by priority): 0 = normal operation 1 = standby 2 = overcurrent protection activated (If>4A) 3 = temperature protection activated (> 90°C speed is decreased, > 105°C motor stops) 4 = internal controller fault 5 = motor misconnected / faulty 6 = too low (<150V) or too high (>265V) supply voltage 7 = motor failed to start repeatedly
23	Operation minutes	0 – 1440	1	Minutes of operation
24	Operation days	0 - 32767	1	Days of operation (RPM > 0, no errors)

Table 10 - available Input Registers - SR and WG EC drives

4.2.2 SNMU EC drives

Input registers - read				
Address	Function	Range	Resolution	Remarks
26883	Status	0 - 65535	1	1 in bit 0 means that the running test has passed
26884	Sequencer state	0/1/2/3/4/ 5/6/7/8	1	0 = power on 1 = stop 2 = measuring offset current 3 = charging bootstrap capacitors 4 = motor running 5 = fault state 6 = catch spin 7 = parking 8 = open loop acceleration
26885	Modbus address	0 – 255	1	Address in Modbus grid
26887	Fault flag	0 - 65535		Bit reading 0 = PWM fault 1 = DC bus critical overvoltage 2 = DC bus overvoltage 3 = DC bus undervoltage 4 = PLL fault 5 = zero speed fault 6 = temperature too high 7 = locked rotor 10 = controller error 12 = parameter load fault 13 = communication fault
26894	Speed	0 – 65535	1RPM	Actual motor speed
26895	Current	0 – 65535	0,01A	Motor current
26900	DC voltage	0 – 65535	1V	DC bus voltage
26902	IGBT temperature	-2000 – 2000	0,1°C	Transistor temperature
26904	Controller temperature	-2500 – 2500	0,1°C	Controller temperature
26908	Power on minutes	0 - 59	1min	Minutes when controller was powered
26909	Power on hours	0 – 65535	1h	Hours when controller was powered
26917	Rated speed	0 – 65535	1RPM	Rated speed of a given drive model
26918	Work minutes	0 - 59	1min	Minutes of operation
26919	Work hours	0 – 65535	1h	Hours of operation

Table 11 - available Input Registers – SNMU EC drives

Holding Registers – read / write				
Address	Function	Range	Resolution	Remarks
26627	Baudrate	9600 / 19200	1	9600 = baudrate 9600 19200 = baudrate 19200
26628	Control mode	0/1	1	0 = Modbus control 1 = 0-10V control
26629	Failsafe speed	0 – MAX RPM	1RPM	Motor target speed when in failsafe mode
26630	Fire speed	0 – MAX RPM	1RPM	Motor target speed when in fire mode
26632	MAX RPM	0 – RATED RPM	1RPM	Maximum allowed speed
26641	Communication loss alarm delay	0 – 65000	0,01s	Time before communication alarm is activated
26644	Parity	0/1/2	1	0 = no parity check 1 = odd 2 = even
26645	Stop bits	1/2	1	1 = 1 stop bit 2 = 2 stop bits
26648	Setpoint	10% RATED RPM – MAX RPM	1RPM	Speed setpoint
26653	Communication alarm source	0/1/2	1	0 = Modbus 1 = 0-10V 2 = none
26662	Alarm relay function	0/1/2	1	0 = fault indication function 1 1 = running operation 2 = fault indication function 2
26668	Failsafe voltage level	0-100	0,1V	Control voltage level, below which alarm is activated when HR26653 = 1
26669	Modbus address	0-255	1	Address in Modbus grid

Table 12 - available Holding Registers – SNMU EC drives

4.2.3 YLDA EC drives

Holding Registers – read / write				
Address	Function	Range	Resolution	Remarks
0	Set speed	0-10000	1RPM	Set speed
1	Modbus address	0-127	1	Modbus address
2	Set current	0-10000	0,01A	Set current
3	Set power	0-10000	1W	Set power
20	Motor direction	0-1	1	Motor direction 0 = left 1 = right
23	MAX RPM	0-10000	1RPM	Maximum speed
24	MIN RPM	0-10000	1RPM	Minimum speed
117	Restart time	0-1000	1s	After-fault restart interval
118	Restart number	0-1000	1	Restart number
206	Operation status	0-2	1	Operation status 0 = default

				1 = operation in progress 2 = success
250	Motor start	0-1	1	Start permission 0 = stop 1 = start
254	Command mode	0-3	1	Control type 0 = 0-10V 1 = PWM 2 = 4-20mA 3 = Modbus
268	0-10V Stop	50-10000	1mV	Control input voltage for stop
269	0-10V Start	50-10000	1mV	Control input voltage for minimum setpoint
270	0-10V Max	50-10000	1mV	Control input voltage for maximum setpoint
271	4-20mA Stop	50-10000	1uA	Control input current for stop
272	4-20mA Start	50-10000	1uA	Control input current for minimum setpoint
273	4-20mA Max	50-10000	1uA	Control input current for maximum setpoint
274	PWM Stop	50-1000	0.1%	Control PWM signal for stop
275	PWM Start	50-1000	0.1%	Control PWM signal for minimum setpoint
276	PWM Max	50-1000	0.1%	Control PWM signal for maximum setpoint
277	ID	0-2555	1	Motor type – dependent ID (for 1.10kW only)
279	Baudrate	3-5	1	Baudrate (for 1.10kW only) 3 = 9600 4 = 19200 5 = 38400
280	Parity - stop	0-3	1	Transmission parameters (for 1.10kW only) 0 = 8E1 1 = 8O1 2 = 8N2 3 = 8N1
281	UART key	0-1024	1	UART key (for 1.10kW only) 0-1023 = off 1024 = on
286	Monitoring	0-1	1	External communication monitoring enabled 0 = off 1 = on
287	Monitoring – timeout	0-65000	1s	External communication monitoring timeout
224-225	Working time	-	h-m	First 24 digits are hours, last 8 digits are minutes
500	Saving parameters	0-100	1	9 = parameters save
2001	Speed	0-10000	1RPM	Actual speed of the motor
2002	Fault code	1-12	1	1 = short circuit 2 = software overcurrent 3 = overvoltage 4 = undervoltage 5 = lack of phase 6 = stalled rotor 7 = overtemperature 8 = out of step 9 = input phase loss

				10 = communication failure 11 = current sampling fault 12 = inverter failure
2003	Frequency limit code	0-32	1	4 = overpower frequency reduction 8 = overvoltage frequency reduction 32 = overtemperature frequency reduction
2004	AC RMS Voltage	0-10000	1V	AC RMS Voltage
2005	RMS phase current	0-100	0.01A	RMS phase current
2006	Input power	0-10000	1W	Input power
229	Temperature	0-200	1C	Controller temperature
2009	DC Bus voltage	0-10000	1V	DC Bus voltage
2010	Work mode	0-4	0	Tryb pracy
2011	X Vibration	0-1000	0,1mm/s	X axis vibration (for 1.10kW only)
2012	Y Vibration	0-1000	0,1mm/s	Y axis vibration (for 1.10kW only)
2013	Z Vibration	0-1000	0,1mm/s	Z axis vibration (for 1.10kW only)

Table 13 - available Holding Registers – YLDA EC drives

4.3 0-10V

In addition to Modbus RTU, VTS EC drives have the ability to be controlled using 0-10V analog signal.

Terminals to which the control signal should be connected are indicated in 3.2 *Pinout* chapter.

One should also make sure that the drive control mode is set to 0-10V:

- **SR and WG EC drives:** Holding Register 6 = 0
- **SNMU EC drives:** HR 26628 = 1
- **YLDA EC drives:** HR 254 = 0

5. Adaptation of new EC drives to work with VTS automation

When ordering EC drives as spare parts (and for site-assembled units), they will have the following settings:

X	SR and WG	SNMU	YLDA
address	1	129	1
baudrate	9600	19200	9600
parity control	none	even	none
stop bits	1	1	1

Table 14 - default settings for EC drives ordered as spare parts

In order to adapt a new EC drive, ordered as a spare part, to work with a given air handling unit, the following are necessary:

- USB-RS485 converter (e.g. Ultima TRB-0611 or other based on FTDI chipset)
- power cable to the motor (L+N+PE for 1ph drives; L1+L2+L3+PE for 3ph drives)
- Modbus master software (e.g. Modbus Poll)

Attention! Factory-assembled VTS units are supplied with drives adapted for operation. The following activities apply only to drives ordered as spare parts and drives in units assembled on site.

After connecting the motor to the power supply and the converter, establish a connection with the motor in the Modbus Poll program in accordance with the default parameters presented in *Table 14*, and then, respectively:

- **for SR and WG EC drives:**

- set Holding Register 5 to value 9788 (password for changing parameters)
- set HR 6 to 2 (control mode = Modbus)
- set HR 8 to 0 (communication loss reaction = motor stop)
- set HR 7 to the value corresponding to the drive address in the AHU - after this change, the connection with the drive should be re-established at the selected address with the following parameters: baudrate 9600, no parity check, 1 stop bit
- set HR 5 to 10000 (password for saving changes)

For SR EC drives there is also the possibility of adaptation using HMI Advanced (without using a converter). To do this, enter the old (default 1) and new (according to *Table 6*) address on the I15 mask and start the setting procedure by selecting the *YES* option. Note that only one drive should be powered up at a time during the procedure.

- **for SNMU EC drives:**

- set Holding Register 26628 to value 0 (control mode = Modbus)
- set HR 26629 to 0 (failsafe speed = 0)
- set HR 26653 to 0 (communication alarm source = Modbus)
- set HR 26627 to 9600 (baudrate = 9600) - after this change, the connection with the drive should be re-established at address 129 with the following parameters: baudrate 9600, even parity, 1 stop bit
- set HR 26644 to 0 (no parity check) - after this change, the connection with the drive should be re-established at address 129 with the following parameters: baudrate 9600, no parity check, 1 stop bit
- set HR 26669 to the value corresponding to the drive address in the AHU

- **for YLDA EC drives:**

- set Holding Register 254 to value 3 (control mode = Modbus)
- set HR 1 to the value corresponding to the drive address in the AHU - after this change, the connection with the drive should be re-established at the selected address with the following parameters: baudrate 9600, no parity check, 1 stop bit
- set HR 500 to 9 (password for saving changes)